



6 x 3m Multipurpose Building

Standard inclusions

- 1 external plain metal door 2043 x 886
- 1 window 1075 x 1155 with flyscreens
- 1 reverse cycle air conditioner
- 1 diffused LED batten lights, 38W
- 1 single socket GPO for ACs, 10 Amps
- 2 double socket GPOs, 10 Amps
- 1 load centre & power entry box

Standard finishes

Exterior:

- Trimdeck® roof cladding (Surfmist)
- CCS Mesa cladding to exterior walls (Merino)
- R2.0 glasswool batts (walls), R4.0 glasswool batts (ceiling)

Interior:

- Pre-finished polyester plywood linings to ceilings (Mirage Pearl)
- Pre-finished polyester plywood linings to walls (White Smoke)
- Seamless vinyl floor coverings
- D Mould skirting & cornice throughout

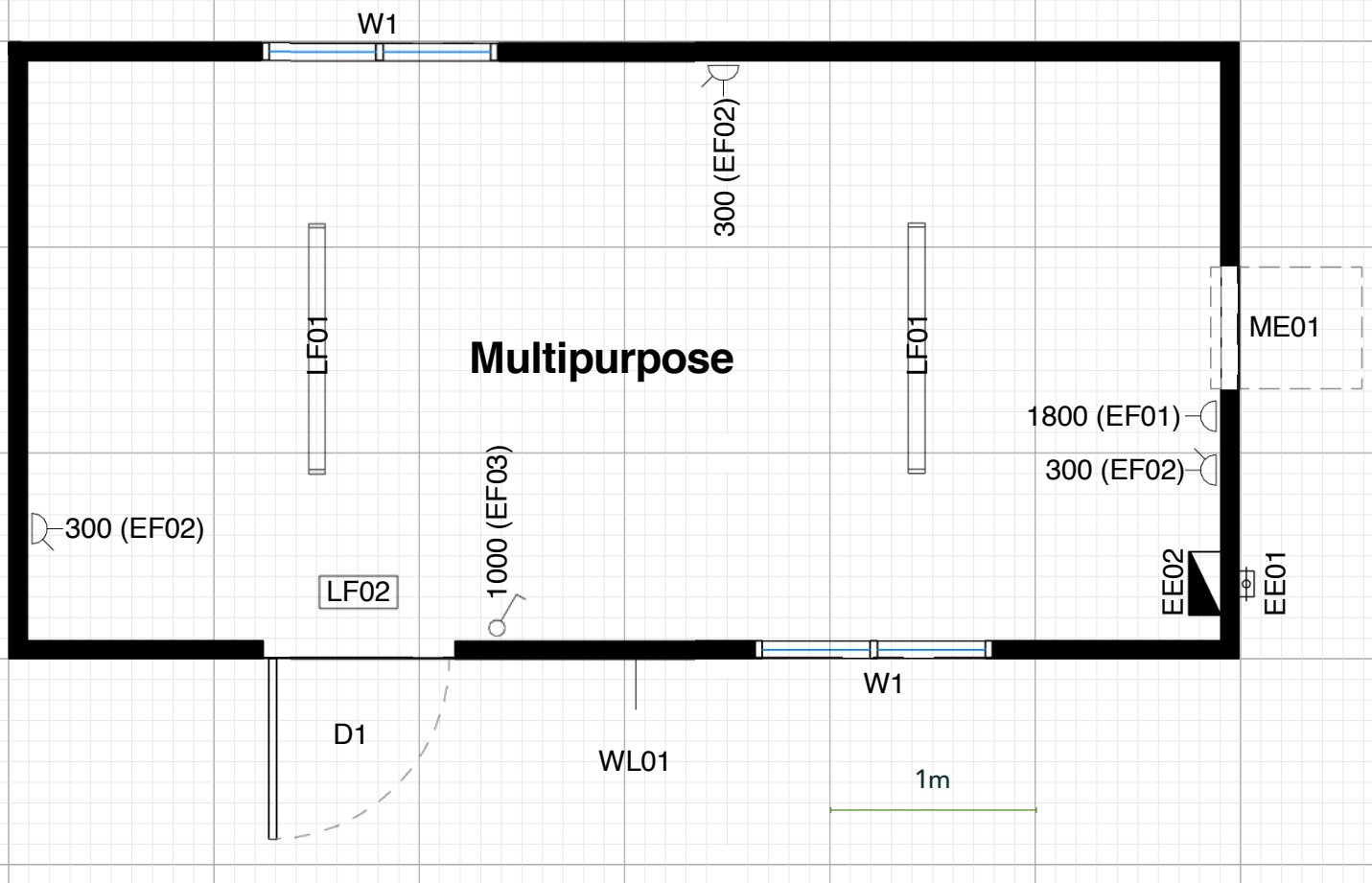

Other options

At Ausco, we understand that you may want to tailor your building to the unique needs of your business. For information about structural, complexing and design options available (including finishes, fixtures and fittings) for this building, please contact your local Ausco representative.

Suggested 360° Solution Products

- Office or meeting room furniture for [hire](#) or [purchase](#)
- [Building Renter Protection](#)
- [Single Step](#)
- [Water Bubblers](#)
- [Building Tie Downs](#)

Browse the full [360° Solutions](#) suite of products and services



AUSCO
MODULAR

13 62 11

ausco.com.au

follow us



Please note: the images and drawings are for illustration purposes only. We have a wide and varied building fleet, and the final buildings may vary from what is shown here.